

**AXENT**  
SWITZERLAND

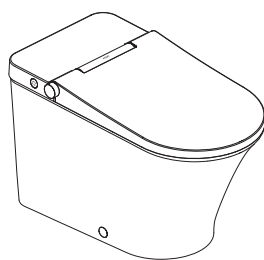

AXENT.ONE C PLUS

**USER** MANUAL



**USER MANUAL  
AXENT.ONE C PLUS**

Safety	2
Introduction	5
Multifunction Dial	8
Remote Control	18
Maintenance	28
Troubleshooting	31
Technical Data	34
Guarantee	35

# SAFETY

## SAFETY SYMBOLS

---

The following warning signs warn you of dangerous situations and their severity:



**DANGER!**

High Risk, Lethal Hazards, Severe Injuries



**WARNING!**

Medium Risk, Severe Injuries



**CAUTION!**

Low Risk, Minor Injuries



**NOTE!**

Damage to Property

## NORMAL USAGE

---

The intelligent toilet's spray arm attachment should only be used for the rear wash and front wash cleaning functions. The product may also be used as a normal toilet seat. This product is meant for indoors usage only.

Any other usage will not be deemed as normal usage. AXENT undertakes no liability for abnormal usage.

AXENT is not liable or responsible for damage to other electronics connect to the same power line while the intelligent toilet is in use.

## IMPORTANT SAFEGUARDS

---

### READ ALL INSTRUCTIONS BEFORE USING

### SAVE THESE INSTRUCTIONS

When using electrical products, especially when children are present, basic safety precautions should always be followed, including the following:



**DANGER!**

#### To reduce the risk of electrocution

**Do not reach for any electrical components of the intelligent seat that have fallen into water. Unplug toilet immediately.**

Unplug product if not in use for extended periods of time.

Do not use while bathing.

Do not place or store product where it can fall or be pulled into a tub or sink.

Do not place or submerge the intelligent toilet or its components into water or other liquids.



**WARNING!**

#### To reduce the risk of burns, electrocution, fire, or injury to persons

Close supervision is necessary when this product is used by, on, or near children or disabled people.

Use this product only for its intended use as described in this manual. Do not use attachments not recommended by the manufacturer.

Never operate this product if it has a damaged cord or plug, if it is not working properly, if it has been dropped or damaged, or dropped into

# SAFETY

Keep the cord away from heated surfaces.

Do not block the air vents on this product. Do not place the toilet on or by objects such as long window curtains that could potentially obstruct the air vents during normal usage. Keep air vents free of lint, hair, and other debris.

Never use while sleepy or drowsy.

Never drop or insert any object into any openings or hoses.

Connect this product to a properly grounded outlet only. See Section «GROUNDING INSTRUCTIONS».

Unplug this product before filling water. Fill (reservoir) with water only unless otherwise specified by manufacturer. Do not overfill.

## SAFETY INSTRUCCIONES

---

Carefully read and observe the following safety instructions!

### Information for the user

Children or persons with limited physical/mental capabilities may require supervision or proper instructions/guidance prior to or during use.

Ensure that children cannot play with intelligent toilet.

### Avoid malfunctions and damage to the product as a result of improper use

If intelligent toilet is moved from a cold location to a warm location, condensation may form. Leave the unit switched off for a few hours.

Do not install the intelligent toilet in rooms where the temperature will be less than 4 °C (39 °F).

Do not place open flames, candles, cigarettes, or similar objects on or by the toilet.

Do not reuse old hoses or water lines. Please use new water lines when installing.

Do not install the intelligent toilet next to items that would potentially expose the toilet to a large amount of water.

Do not climb on or stand on the product.

Do not place any heavy objects on the lid.

Do not open or close the lid or seat with force.

Do not deliberately soil, spray or block the spray arm.

### Repairs must only be carried out by a person with the necessary expertise

Do not carry out modifications, tamper with, install additional equipment, or attempt to repair the intelligent toilet.

Improperly performed repairs can lead to accidents, injuries, or damage to the product.

### Only use the device when it is fully functional

Make sure the power cable is not damaged before use. Do not allow the power cable to be severely pinched, bent, or kinked.

Keep the power cable away from hot surfaces and sharp edges.

Do not handle the power cable or plug with wet hands.

Do not use the product if it is not working properly. In case of malfunction, disconnect the power immediately. Close the water cut-off valve to interrupt the water supply. Contact your installer.

### Information on the use of batteries

Keep batteries out of the reach of small children. Batteries can be life-threatening if swallowed. If a battery has been swallowed, seek medical assistance immediately.

Do not attempt to recharge non-chargeable batteries for use with unit.

Always remove empty batteries from the remote control immediately. They may leak and cause damage.

Do not insert new and old batteries together in the remote control.

Clean the battery and contacts before inserting the battery. Make sure the batteries are oriented properly.

Remove the batteries if you do not use the remote control for an extended period.

Do not expose the batteries to hot surfaces or direct sunlight to reduce the risk of battery leakage.

If battery acid has leaked, avoid contact with skin, eyes and mucous membranes. In case of contact with the acid, flush the affected areas with large amounts of clean water and seek medical assistance immediately.

# SAFETY

## GROUNDING INSTRUCTIONS

This product must be grounded when plugged in. The power cord on this product has a grounding plug and must be plugged into an outlet with a properly grounded grounding plug.



### DANGER!

**Improper use of grounding plug can result in a risk of electric shock**

If repair or replacement of the power cord or plug is necessary, do not connect the grounding wire to either flat blade terminal.

This product is factory equipped with a specific electric cord and plug to permit proper connection. No adapters should be used with this product. Do not modify the power cord on the toilet. If the power cord will not fit the outlet, have the proper outlet installed by a qualified electrician. If the product must be reconnected for use on a different type of electric circuit, the reconnection should be made by qualified service personnel.

If it is necessary to use an extension cord, use only a three prong

extension cord that has a three-blade grounding plug, and a three-slot receptacle that will accept the plug on the product. Replace or repair a damaged cord.

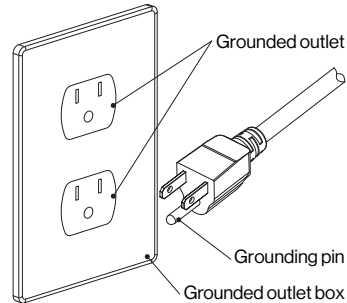

Wiring Diagram (NOT FOR INSPECTOR'S USE)



### NOTE!

Actual installation may differ slightly from the diagram.

## FCC INSTRUCTIONS

Please note that changes or modifications not expressly approved by the party responsible for compliance could void the user's authority to operate the equipment.

Note: This equipment has been tested and found to comply with the limits for a Class B digital device, pursuant to part 15 of the FCC Rules. These limits are designed to provide reasonable protection against harmful interference in a residential installation. This equipment generates, uses and can radiate radio frequency energy and, if not installed and used in accordance with the instructions, may cause harmful interference to radio communications. However, there is no

guarantee that interference will not occur in a particular installation. If this equipment does cause harmful interference to radio or television reception, which can be determined by turning the equipment off and on, the user is encouraged to try to correct the interference by one or more of the following measures:

- Reorient or relocate the receiving antenna.
- Increase the separation between the equipment and receiver.
- Connect the equipment into an outlet on a circuit different from that to which the receiver is connected.
- Consult the dealer or an experienced radio/TV technician for help.

## TECHNICAL SUPPORT

For any questions or any assistance with this product, please contact your dealer or call us at

1-800-769-4857

support@axentproducts.com

www.axentbathus

# INTRODUCTION

## OVERVIEW

---

Model AXENTONE C PLUS

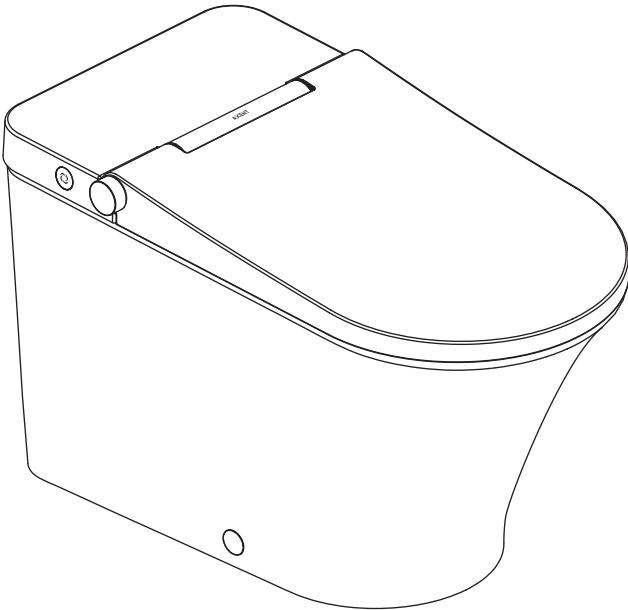

Remote Control: Standard Model

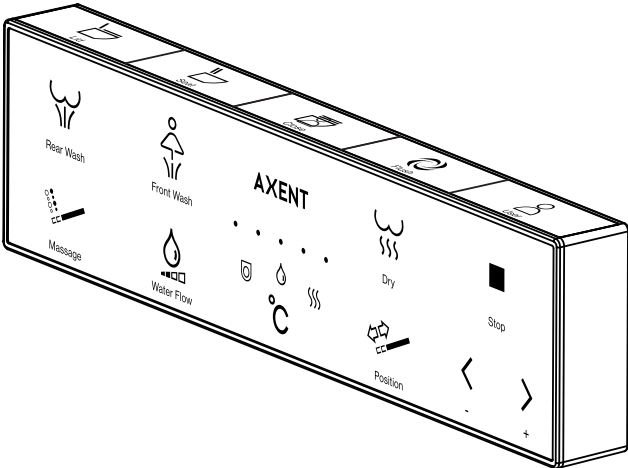

AXENTONE C PLUS

E322-02

# INTRODUCTION

## REMOTE CONTROL

Activate the remote control by inserting the batteries.

For safety purposes, the bidet function of the intelligent toilet is only functionally activated when you are seated on the toilet seat.

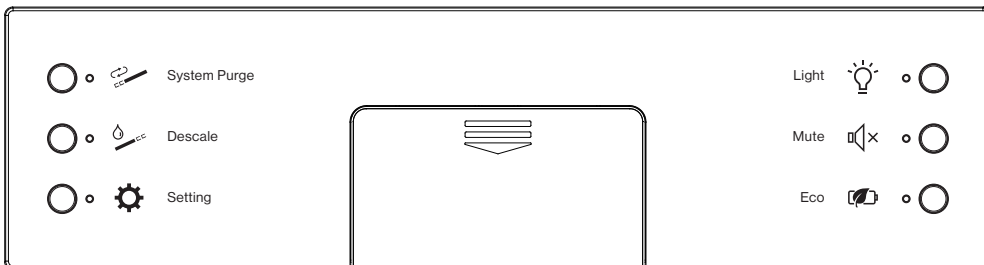
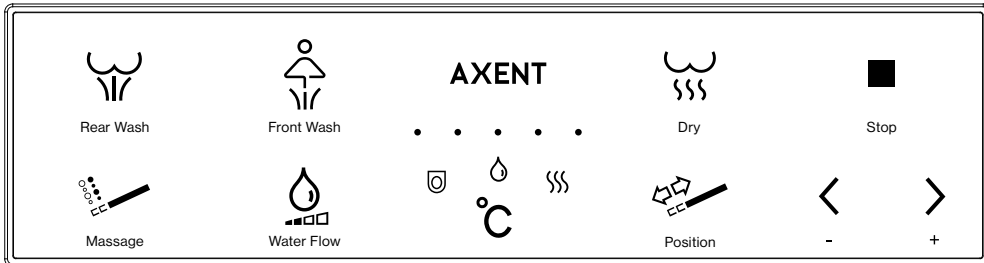
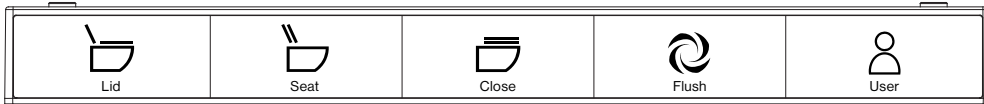



# INTRODUCTION

## MULTIFUNCTION KNOB

The intelligent toilet can be easily operated by the multifunctional dial and buttons.

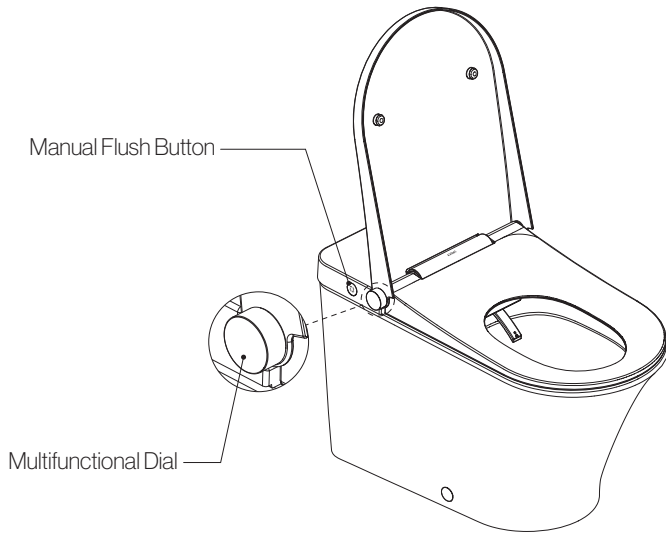

Drain (Page 28)

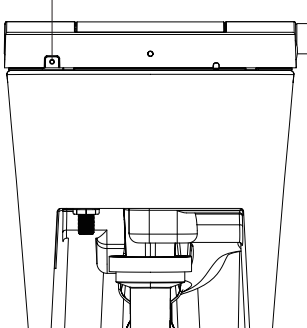

# MULTIFUNCTION DIAL

## QUICK START

---

AXENT.ONE C PLUS offers a Quick Start function. Sit down on the toilet seat and push the dial. Rear Wash starts and will stop after another push on the button.



The spray arm is automatically cleaned with water before and after each washing procedure.



# MULTIFUNCTION DIAL

## REGULAR USE

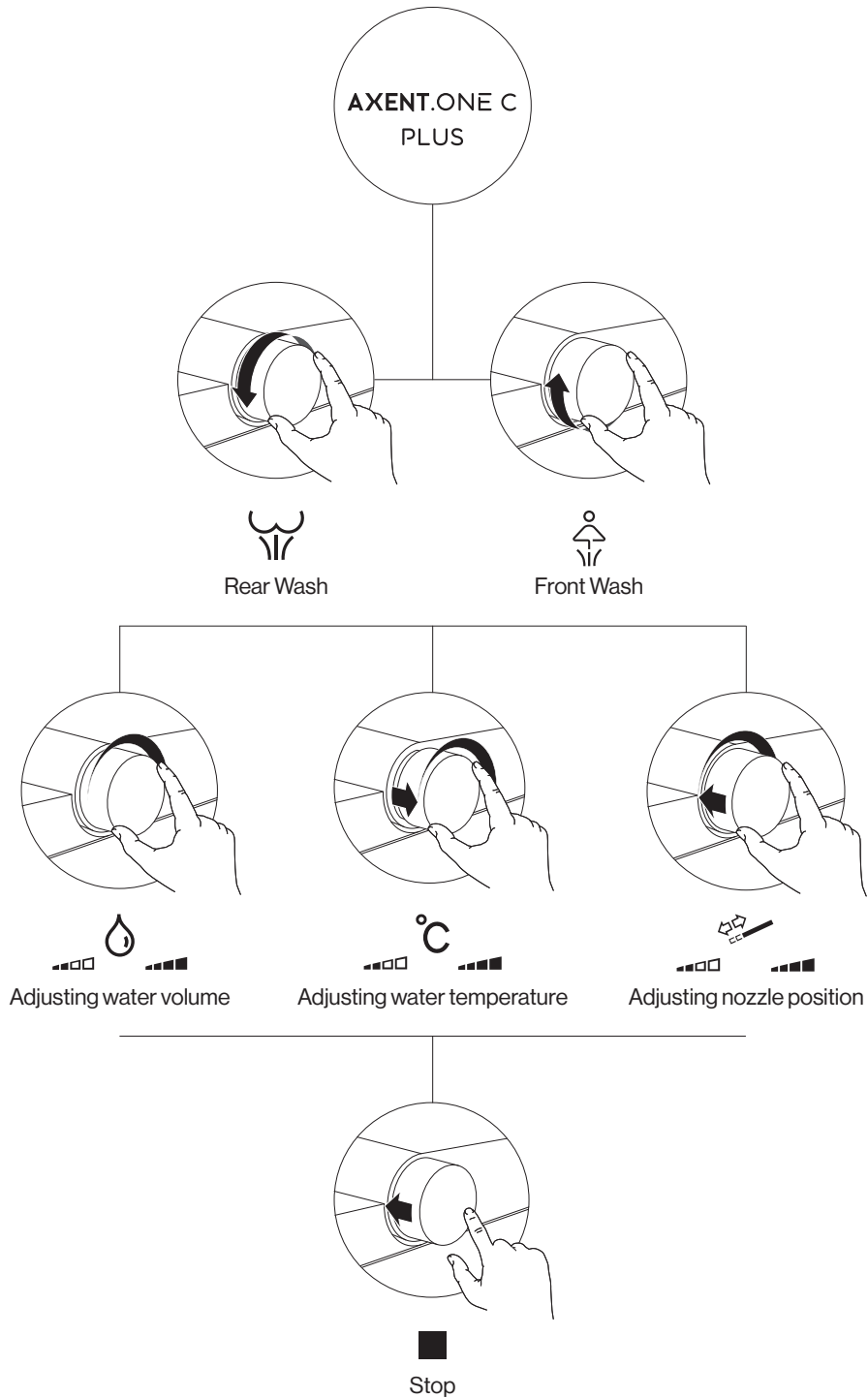

# MULTIFUNCTION DIAL

## ADDITIONAL FEATURES

---

Additional settings and service functions may also be accessed with the multifunction dial. Access is done at two levels.

### LEVEL 1

- Mute ON / OFF
- Seat heating ON / OFF
- Self-cleaning function ON / OFF
- System purge

### LEVEL 2

- Night light ON / AUTO / OFF
- Deodorizer ON / OFF
- Auto dry
- Spray arm cleaning
- System reset

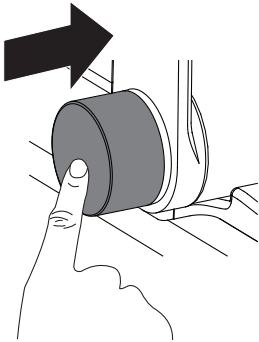

### ACTIVATING LEVEL 1

---

To activate LEVEL 1, press the multifunction dial for 5 seconds until the ambient light flashes slowly. The ambient light will continue to flash slowly while in LEVEL 1.

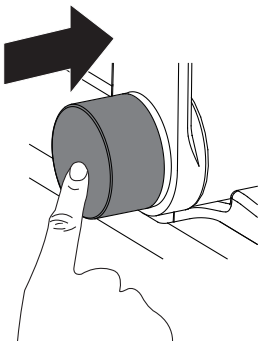

### DEACTIVATING LEVEL 1

---

When the multifunction dial is already in LEVEL 1, push the dial. The ambient light will stop flashing and you will hear one single <<beep>>. The mode level 1 is deactivated.



If not functions are accessed in 3 minutes, LEVEL 1 will automatically deactivate.

# MULTIFUNCTION DIAL

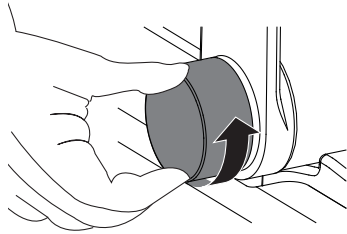

LEVEL 1	MUTE	ON / OFF
---------	------	----------

Factory setting:	Mute is ON
------------------	------------

When the multifunction dial is already in LEVEL 1, the ambient light flashes slowly.  
 - Turn the multifunction dial counter clockwise.

One time «beep»:	Mute is ON
Two times «beep»:	Mute is OFF

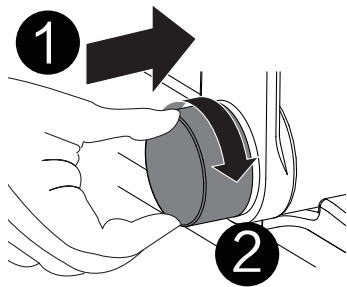

LEVEL 1	SEAT HEATING	ON / OFF
---------	--------------	----------

Factory setting:	Seat heating is ON
------------------	--------------------

When the multifunction dial is already in LEVEL 1, the ambient light flashes slowly.  
 - Press and hold the multifunction dial.  
 - Turn it clockwise.

One time «beep»:	Seat heating is ON
Two times «beep»:	Seat heating is AUTO
Three times «beep»:	Seat heating is OFF

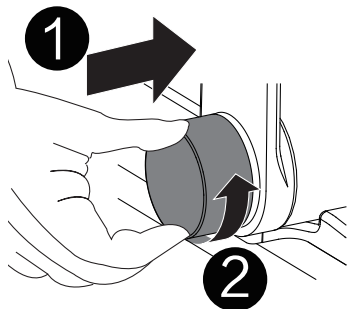

LEVEL 1	SELF-CLEANING FUCTION	ON / OFF
---------	-----------------------	----------

As soon as you sit down on the toilet seat, the spray arm will be cleaned with fresh water.  
 This function can be turned ON or OFF.

Factory setting:	Self-cleaning function is ON
------------------	------------------------------

When the multifunction dial is already in LEVEL 1, the ambient light flashes slowly.  
 - Press and hold the multifunction dial.  
 - Turn it counter clockwise.

One time «beep»:	Self-cleaning function is ON
Two times «beep»:	Self-cleaning function is OFF

# MULTIFUNCTION DIAL

## **LEVEL 1            SYSTEM PURGE**

---

If the toilet has not been used for a long period of time, old water may be purged from the system and replaced with fresh water.

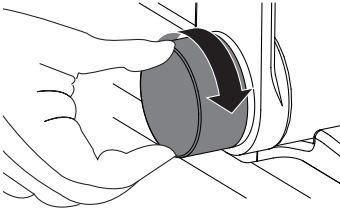

When the multifunction dial is already in LEVEL 1, the ambient light flashes slowly.

- Turn multifunction dial clockwise.
- You will hear one «beep». The system purge has started.

The system purge process stops after 90s automatically.



Turn multifunction dial clockwise again to stop the system purge procedure immediately.

# MULTIFUNCTION DIAL

## ACTIVATE FUNCTIONS AT LEVEL 2

When the multifunction dial is already in LEVEL 1, push the dial again for 5 seconds until the ambient light flashes quickly. The mode level 2 is activated, and the ambient light keeps on flashing quickly.

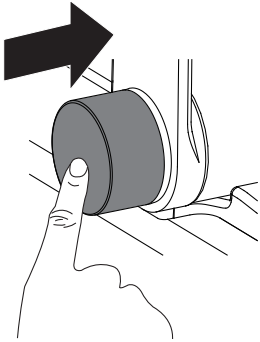

## DEACTIVATE FUNCTIONS AT LEVEL 2

When the multifunction dial is already in LEVEL 2, push the dial. The ambient light will stop flashing and you will hear one single <<beep>>. The mode level 2 is deactivated.

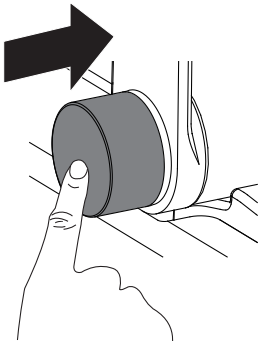

If not functions are accessed in 3 minutes, LEVEL 2 will automatically deactivate.

LEVEL 2	NIGHT LIGHT	ON / OFF
---------	-------------	----------

Factory setting:

AUTO mode – the brightness will be adapted according to the ambience.

When the multifunction dial is already in LEVEL 2, the ambient light flashes quickly.

- Turn multifunction dial counter clockwise.

One time «beep»:

Night light function is ON

Two times «beep»:

Night light function is AUTO

Three times «beep»:

Night light function is OFF

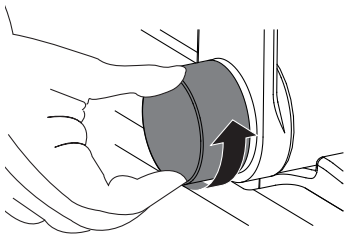

# MULTIFUNCTION DIAL

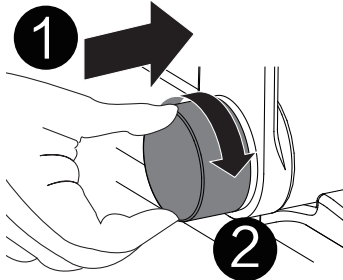

LEVEL 2	DEODORIZER	ON / OFF
---------	------------	----------

Factory setting:	Deodorizer is ON
The deodorizer function is activated when a user is seated.	

When the multifunction dial is already in LEVEL 2, the ambient light flashes quickly.

- Press and hold the multifunction dial.
- Turn it clockwise.

One time «beep»:	Deodorizer is ON
Two times «beep»:	Deodorizer is OFF

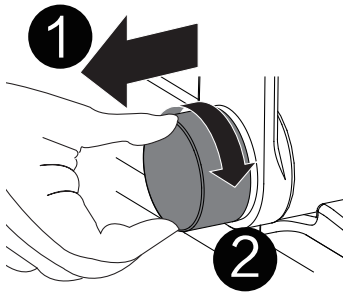

LEVEL 2	AUTO DRY	ON / OFF
---------	----------	----------

Factory setting:	Auto dry is OFF
The Auto dry function is started when a user press the multifunction dial during Rear or Front Wash.	

When the multifunction dial is already in LEVEL 2, the ambient light flashes quickly.

- Pull and hold the multifunction dial.
- Turn it counter clockwise.

One time «beep»:	Auto dry is ON
Two times «beep»:	Auto dry is OFF



# MULTIFUNCTION DIAL

## **LEVEL 2      SPRAY ARM CLEANING**

---

When the multifunction dial is already in LEVEL 2, the ambient light flashes quickly.

- Turn the multifunction dial clockwise.

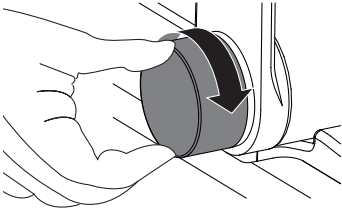

The spray arm will move out.

- Clean the spray arm with fresh water. Wipe with a soft cloth or fabric.
- Turn the multifunction dial clockwise again.

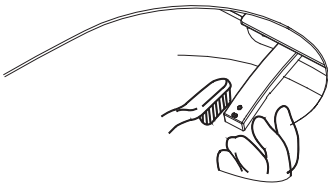

The spray arm will move back to its position.

# MULTIFUNCTION DIAL

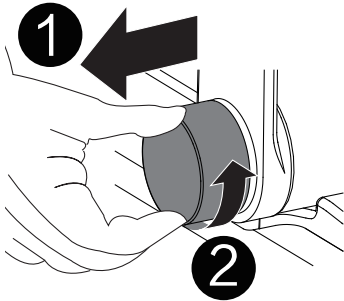

## LEVEL 2 SYSTEM RESET

---

When the multifunction dial is already in LEVEL 2, the ambient light flashes quickly.

- Pull the multifunction dial.
- Turn it counter clockwise.

One time «beep»:

All values are reset to factory settings

If you turn the multifunction dial again, a 3 seconds «beep» will inform you that the system will be re-started.

## STAND-BY MODE

---

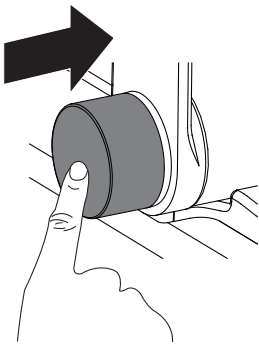

Press and hold the multifunction dial until ambient light off to activate the Stand-by mode. In Stand-by mode, there is no activity for some time.

Slightly knock the toilet lid to deactivate the Stand-by mode.

# MULTIFUNCTION DIAL

## SYNCHRONIZING TO REMOTE

---

Cut off the power of the intelligent toilet and then apply power to it.

After three times «beep»,  
start pairing by pressing multifunction dial 5 times within 20 seconds.

- Three times «beep» from the intelligent toilet confirms successful synchronization.

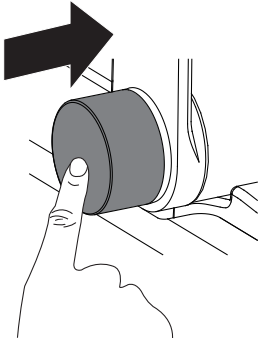

Note that each dial and remote are paired from the factory. This is only necessary if the remote or dial are being or have been replaced.

# REMOTE CONTROL

## REMOTE CONTROL

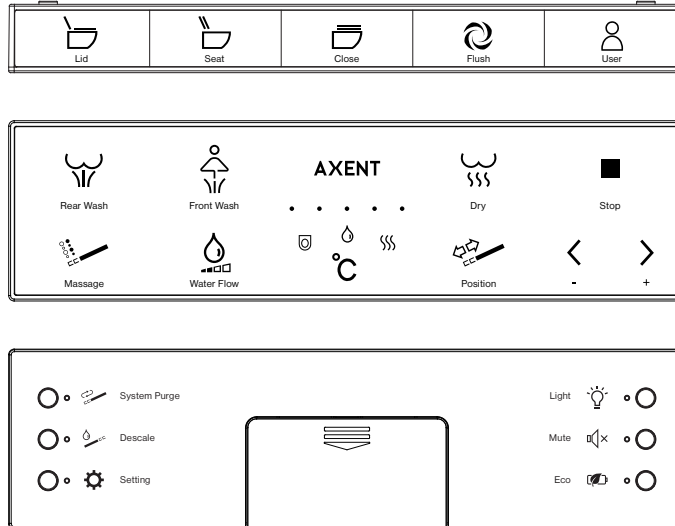

## REMOTE CONTROL ON/OFF/REPLACING BATTERIES

ON: Insert batteries.

OFF: Remove batteries.

Replaying batteries: When power is below 15%, the first and last of Level Indicator will blink on and off, indicating the battery needs to be replaced.



Do NOT insert new and old batteries together in the remote control.

## STAND-BY MODE REMOTE CONTROL

The remote control enters into the standby mode automatically and all indicator lights turn off when there is no activity for some time. Press any icon to exit the stand-by mode.

# REMOTE CONTROL

## PAIRING

---

Cut off the power of the intelligent toilet and then apply power to it.



After three times «beep», start pairing by pressing « Stop » 5 times within 20 seconds.  
- Three times «beep» from the intelligent toilet confirms successful pairing.



Pairing has originally been done in the factory. It is necessary only after you replaced your remote control.

## OPENING AND CLOSING THE SEAT AND LID

---



Press « Lid » after leaving the seat; open the lid or close the seat.  
- When Auto open setting is Lid, lid will be opened automatically when you are around.



Press « Seat » after leaving the seat; open the lid and seat.  
- When Auto open setting is Seat, lid and seat will be opened automatically when you are around.



Press « Close » after leaving the seat; close the lid and seat.  
- Lid and seat will be closed automatically 2 minutes after leaving.



Auto open only works when the lid is closed and 10 sec. after last Auto open.  
Please do not put things on the lid or seat.

## FLUSH

---



Press « Flush » to start.  
- Leave the seat after you are seated over 5sec. and the function will be started after a period of time defined by the Auto flush setting which defaults to 15 seconds.

# REMOTE CONTROL

## FRONT OF REMOTE CONTROL

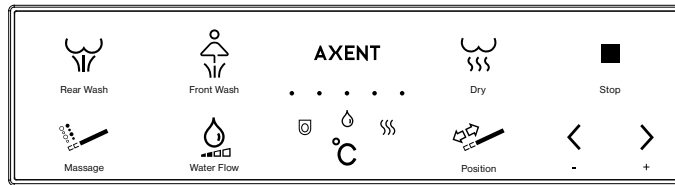

## REAR WASH



Rear Wash

Press « Rear Wash » after you are seated to start.



Stop

Press « Stop », to stop the Rear Wash early.  
If not halted manually the Rear Wash will stop automatically after 3 minutes.



Press « Rear Wash » to start procedure again if required.

## FRONT WASH



Front Wash

Press « Front Wash » after you are seated to start.



Stop

Press « Stop », to stop the Front Wash early.  
If not halted manually the Front Wash will stop automatically after 3 minutes.



Press « Front Wash » to start procedure again if required.

## OSCILLATING AND PULSATING SHOWER



Massage

Press « Massage » once to start Oscillating.  
Press « Massage » twice to start Pulsating.  
Press « Massage » thrice to start Oscillating and Pulsating.

# REMOTE CONTROL

## WATER VOLUME

---



Water Volume

Press « Water Volume » during Rear or Front Wash to activate water volume adjustment.  
The Level Indicator indicates the selected level.



Minus

Press « Minus » to reduce the water volume.



Plus

Press « Plus » to increase the water volume.

## SPRAY ARM POSITION

---



Position

Press « Position » during Rear or Front Wash to activate spray arm position adjustment.  
The Level Indicator indicates the selected level.



Minus

Press « Minus » to move the Spray Arm backward.



Plus

Press « Plus » to move the Spray Arm forward.

## DRY

---



Dry

Press « Dry » after you are seated to start.



Stop

Press « Stop », to stop the Dry early.  
If not halted manually the Dry will stop automatically after 3 minutes.



Press « Dry » to start procedure again if required.

# REMOTE CONTROL

## FRONT OF REMOTE CONTROL

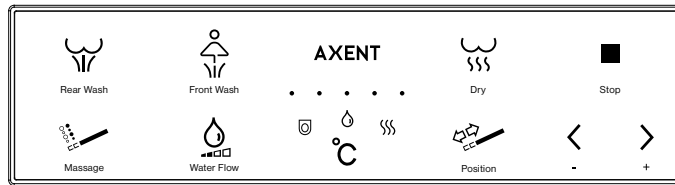

## TEMPERATURE ADJUSTMENT



Temp

Press « Temp » repeatedly until the symbol Seat Temp lights up to activate seat temperature adjustment;  
Or press « Temp » repeatedly during Rear and Front Wash until the symbol Water Temp lights up to activate water temperature adjustment;



Seat Temp

Or press « Temp » repeatedly during Dry until the symbol Air Temp lights up to activate air temperature adjustment.

The Level Indicator indicates the selected level.



Water Temp



Air Temp



Minus

Press « Minus » to reduce the temperature.



Plus

Press « Plus » to increase the temperature.



# REMOTE CONTROL

## TOP OF REMOTE CONTROL



## BACK OF REMOTE CONTROL

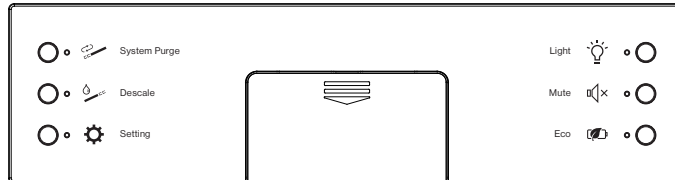

## NIGHT LIGHT SETTING



Factory setting: Night light setting is AUTO - the brightness will be adapted according to the ambience.

Press « Light » to enter into the setting.  
Press « Light » to switch among ON, OFF and AUTO.

The indicator indicates the selected option:

- |        |  |
|--------|--|
| - ON   | The indicator on.                                  |
| - AUTO | The indicator blinks 3 times and turns on.         |
| - OFF  | The indicator blinks for one second and turns off. |

## MUTE SETTING



Factory setting: Mute setting is OFF.

Press « Mute » to set the mute mode ON or OFF.

The indicator indicates the selected option:

- |       |  |
|-------|--|
| - ON  | The indicator on.                                  |
| - OFF | The indicator blinks for one second and turns off. |

## ECO SETTING



Factory setting: Eco setting is OFF.

Press « Eco » to turn on or off the function.

The indicator indicates the selected option:

- |       |  |
|-------|--|
| - ON  | The indicator on.                                  |
| - OFF | The indicator blinks for one second and turns off. |

# REMOTE CONTROL

## TOP OF REMOTE CONTROL

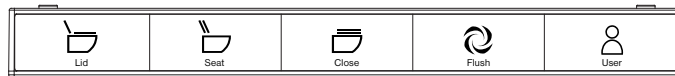

## BACK OF REMOTE CONTROL

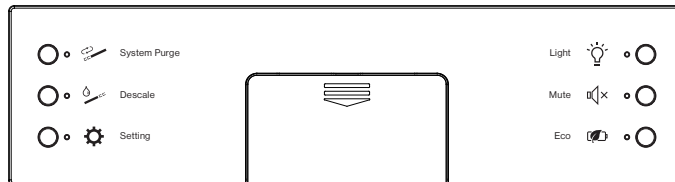

## AUTO OPEN SETTING



Factory setting: Auto Open setting is Seat.



Press « Setting » at the same time « Lid » to activate Auto Open Setting.  
Press « Lid » repeatedly to switch among OFF, seat and Lid.

The Level Indicator indicates the selected level:

- OFF One indicator on.
- Seat Three indicators on.
- Lid Five indicators on.

## SENSE AREA SETTING



Factory setting: Sense Area function is Regular.



Press « Setting » at the same time « Seat » to activate Sense Area Setting.  
Press « Seat » repeatedly to switch among Near, Regular and Far.

The Level Indicator indicates the selected level:

- Near One indicator on.
- Regular Three indicators on.
- Far Five indicators on.

# REMOTE CONTROL

## AUTO CLOSE SETTING

---



Setting

Factory setting: Auto Close function is ON.



Close

Press « Setting » at the same time « Close » to activate Auto Close Setting.  
Press « Close » repeatedly to turn on or off the function.

The Level Indicator indicates the selected level:

- OFF One indicator on.
- ON Five indicators on.

## AUTO FLUSH SETTING

---



Setting

Factory setting: Auto Flush function is 15 seconds.



Flush

Press « Setting » at the same time « Flush » to activate Auto Flush Setting.  
Press « Flush » repeatedly to switch among OFF, 5 seconds, 10 seconds, 15 seconds and 20 seconds.

The Level Indicator indicates the selected level:

- OFF One indicator on.
- 5 sec. Two indicators on.
- 10 sec. Three indicators on.
- 15 sec. Four indicators on.
- 20 sec. Five indicators on.

## DEODORIZE SETTING

---



Setting

Factory setting: Deodorize function is ON.



Mute

Press « Setting » at the same time « Mute » to turn on or off the function.

The indicator indicates the selected option:

- ON The indicator on.
- OFF The indicator blinks for one second and turns off.

## SELF CLEANING SETTING

---



Setting

Factory setting: Self Cleaning function is ON.



Eco

Press « Setting » at the same time « Eco » to turn on or off the function.

The indicator indicates the selected option:

- ON The indicator on.
- OFF The indicator blinks for one second and turns off.

# REMOTE CONTROL

## TOP OF REMOTE CONTROL



## BACK OF REMOTE CONTROL

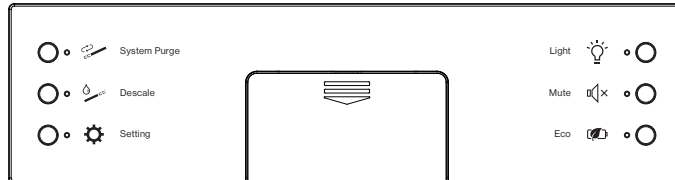

## USER PROFILE



Press « User » to switch among different user profiles. There are 5 user profiles in total.

The Level Indicator indicates the selected user profile.

Functions will conform with the settings defined by the user profile selected.

The change of user's setting will be saved automatically when profile setting mode is on.

You will exit user profile mode after activating the stand-by mode of the remote control for a moment.

## SYSTEM PURGE



System Purge

After a long time of not using the intelligent toilet, all water bearing parts can be exchanged with fresh water.

Press « System Purge » to turn on function.

The system purge process stops after 90s automatically.

# REMOTE CONTROL

## SPRAY ARM CLEANING

---



Press « Descal » to turn on function.

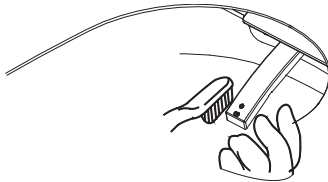

The spray arm will move out.  
- Clean the spray arm with a fabric or a soft bristle brush.  
- Press « Descal » again.

The spray arm will move back to its position.



If no operations are done within 3 minutes, the spray arm will move back automatically.

## RESET

---



The function will make the remote control and intelligent toilet be reset to the factory settings.

Press « Eco » at the same time turn on the remote control by pressing « Setting » for 2 seconds to restor factory settings.

## APP

---

Users of Android and IOS could scan the following QR code to download and install the app named "AXENT Intelligent Control" so that your device (such as smart phones and tablets etc. ) are capable of controlling this product remotely.



Requires Bluetooth 3.0 or later.  
Requires IOS8.0 or later.

# MAINTENANCE

## DURING VACATION

---

If this product will not be in use for an extended period of time, please disconnect the electrical power.

- Disconnect the electrical power.
- Shut off the angle valve.
- Press Manual Flush button.

## WINTERIZATION

Please ensure water temperatures will not drop below 39 °F. Frost or frozen water will damage the system and may lead to leakage.

If the water or ambient temperature drops below 39 °F , please discontinue use of product. Additionally, if the intelligent toilet is moved from a cold location to a warm location, condensation may form. Leave the unit switched off for a few hours before use.

- Disconnect the electrical power.
- Shut off the angle valve.
- Press Drain button (page 7) for 5 seconds, and empty the water inside.
- Discharge the side on the angle valve of the hose-set and empty the hose-set.
- Press Manual Flush button.



FAILURE TO DRAIN SYSTEM MAY RESULT IN DAMAGE TO SYSTEM AND LEAKAGE OR FLOODING.

## CLEANING INSTRUCTIONS SEAT, LID AND BACK COVER

---

Use a mild soap solution to clean the seat and please take care that the seat and hinges are not left damp. Dry off any residual water or cleaning agent with a soft cloth. Avoid contact of the seat and hinges with abrasive, corrosive or chlorine-based cleaners, as these may cause damage or lead to flash rust. Therefore, when cleaning the bowl, make sure that the seat and cover are kept in an upright position until all cleaning agent has been flushed away.



### **DISCONNECT THE MAIN PLUG BEFORE YOU START WITH CLEANING THE PRODUCT.**

**For cleaning do NOT use any scouring equipment (eg. sponge scorers) tools or any aggressive cleaning agents.**

**The toilet seat is firmly connected to the unit and cannot be removed.**

## CLEANING CERAMIC APPLIANCES

---

Under no circumstances should you use harsh or abrasive cleaning substances such as abrasive cleansers, scouring powder or drain cleaner on your ceramic surfaces. Also avoid using steam cleaners and hard, abrasive sponges. Please bear in mind that hair colouring products can reduce the effectiveness of AXENT Easy Clean.

If you follow this guidance then you should remain satisfied with the performance of AXENT Easy Clean for many years. Recommended cleaners for sanitary ceramic surfaces with AXENT Easy Clean finish. The use of acidic cleaners with a pH value between 1 and 4 is highly recommended. Cleaners with a pH value in the neutral range (5 to 8) are not always suitable. We strongly advise against using either weak or strong alkaline cleaners, i.e. substances with pH values from 9 to 12.

# MAINTENANCE

## REMOVING THE TOILET SEAT AND LID



The toilet seat and lid can be removed, cleaned and remounted quickly and easily when heavily soiled.

1. Lift up the toilet seat and toilet lid.
2. Remove the toilet seat and toilet lid by vertical lifting them out of the bracket.
3. Clean the toilet seat and toilet lid.
4. Insert the toilet seat and toilet lid vertically from the top into the bracket in the same way as removed.
5. Let the toilet seat and toilet lid glide down.

## UNINSTALLING AND INSTALLING THE LID AND SEAT

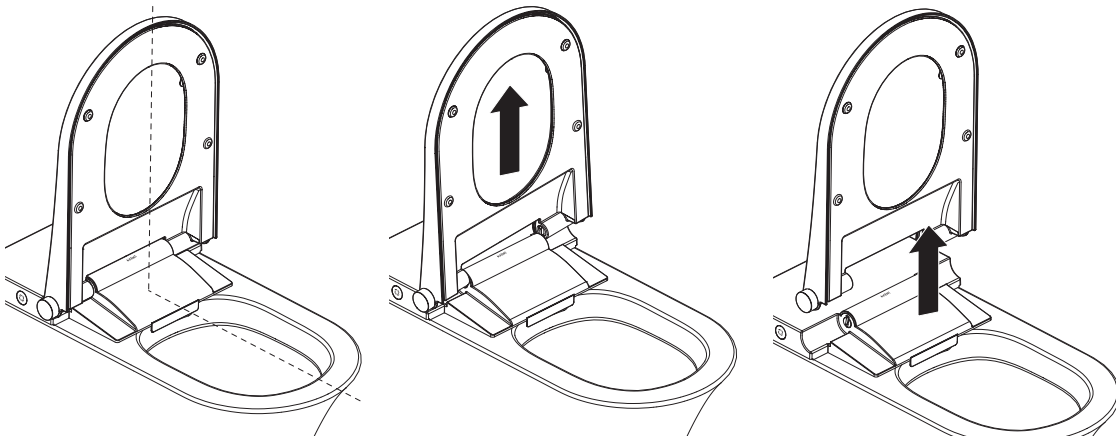

## INSTALLING THE LID AND SEAT

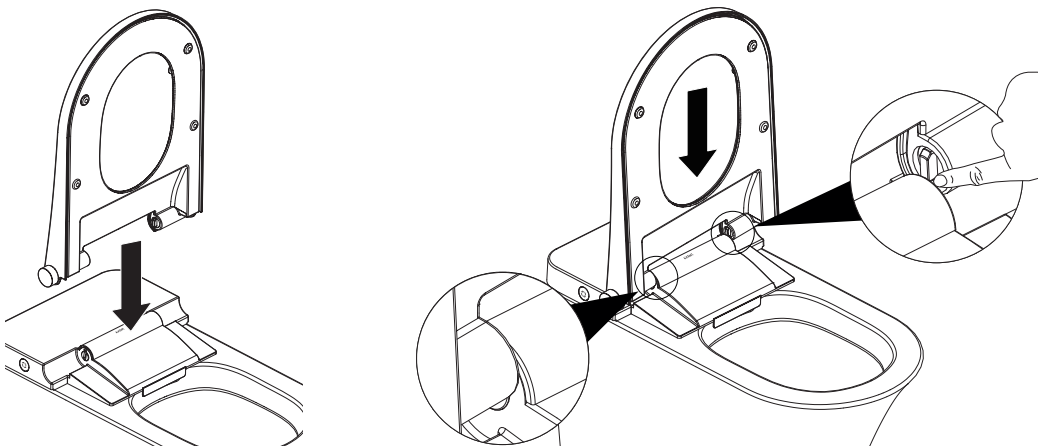

# MAINTENANCE

## SUITABLE CLEANING DETERGENTS

---

- Mild bathroom or all-purpose cleaner
- Mild detergents
- Normal toilet brushes
- Soft sponges
- Microfiber cloth

## UNSUITABLE DETERGENTS

---

- Scouring detergents as sand or abrasive cleaning powder
- Aggressive cleaning agents containing chlorine, bleach, solvents or acid.
- Eye- and skin-irritating detergents
- Scouring sponges

## FILTER CLEANING

---

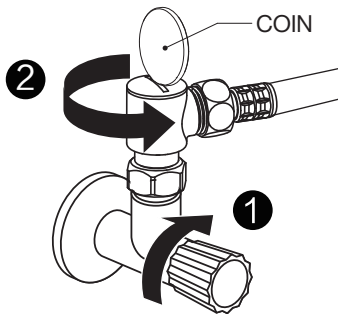

The filter net could be detached as shown in the graph on the left wash it with clean water.



When the water flow is less than normal, please clean the filter.

During the whole cleaning process, the product and hose should be separated.  
Please assure that the angle valve is shut off.  
Please put the filter back in reversed sequence after cleaning it.

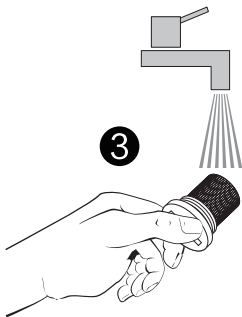



# TROUBLESHOOTING

**SHOULD YOU HAVE ANY QUESTIONS, PLEASE DON'T HESITATE TO CALL YOUR DISTRIBUTOR OR INSTALLATION PROFESSIONAL. OUR TECHNICAL SUPPORT IS ALSO HERE TO HELP.**



## **ELECTRICAL SHOCK! FATAL DANGER!**

Never open the unit in order to repair it yourself. Never modify the device or add any additional modules. The AXENT intelligent toilet carries live parts and opening it exposes those present to fatal danger!

Warranty and liability claims as a result of wrong handling are specifically excluded.

## **RESET**

Perform a reset, if needed. Unplug the Axent toilet bidet and wait for 30 seconds, then reconnect the toilet with the main plug.

<b>Malfunction</b>	<b>Cause</b>	<b>Remedy</b>	<b>Page</b>
No function	Product in Stand-by mode	Please slightly knock the toilet lid to deactivate Stand-by mode.	16
Remote control does not work	The storage battery low	Replace batteries.	/
Level Indicator blinks on and off	The storage battery low	Replace batteries.	/
Remote control does not sensitive	Beyond the inductive distance	Please use the remote control within the inductive distance.	/
Spray arm move out too slowly	Self-cleaning	Please wait for a moment.	/
Low water volume	Water volume set too low	Increase water volume.	21
Low water temperature	Water temperature set too low	Increase water temperature.	22
Water stop suddenly	Leaving the seat during washing	Seated and restart the washing.	20

# TROUBLESHOOTING

Malfunction	Cause	Remedy	Page
Spray arm extending without water spraying out	Seat fails to sense seated	Move or reseated to cover the sensing area and restart the function.	20
Dry does not working	Seat fails to sense seated	Move or reseated to cover the sensing area and restart the function.	20
Low air temperature	Air temperature set too low	Increase air temperature.	22
Massage does not work	Started not during washing	Restart massage during washing.	20
Low seat temperature	Seat temperature set too low	Increase seat temperature.	22
High seat temperature	Seat temperature set too high	Reduce seat temperature.	22
Low seat temperature when seated and go normal then	Eco mode on	Turn off Eco mode.	23
Auto open does not work	Auto open off	Set auto open as Lid or Seat.	24
	Lid not closed	Close lid.	19
	Less than 10 sec. after last Auto Close	Wait for 10 sec. after last Auto Close.	/
Seat not opened by Auto Open	Auto open is off or set as Lid	Set Auto Open as Seat	24
	Lid not closed	Close lid.	/
	Less than 10 sec. after last Auto Close	Wait for 10 sec. after last Auto Close.	/
Auto close does not work	The user still moving within the inductive distance	Leave the inductive distance or be static for 2 minutes	/

# TROUBLESHOOTING

Malfunction	Cause	Remedy	Page
Deodorize does not work	Deodorize off	Turn on Deodorize.	25
	Seat fails to sense seated	Move or reseat to cover the sensing area and Deodorize will start automatically.	/
	During washing	Wait for washing to finish and Deodorize will start automatically.	/
Deodorize still works after leaving seat	Deodorize continues for 60 seconds after leaving seat for better effect	Normal.	/
Night light does not work	Night light in OFF mode	Switch night light setting to ON or AUTO mode.	23
Night light always on	Night light in ON mode	Switch night light setting to AUTO or OFF mode.	23
Spray arm moving back automatically during Descale working	No operations are done within 3 minutes after it moves out	Please restart the spray arm cleaning.	27
Water is spraying out when turning on Descale	Sensing area covered by conducting medium	Please remove the conducting medium.	/
Continuous «beep»	Water temperature too high	Disconnect the main plug and contact customer service.	4
Leakage protector trips frequently	Current leakage exceeds the normal value	Disconnect the main plug and contact customer service.	4

# TECHINCAL DATA

---

Nominal voltage	120 V~, 60 Hz
Power consumption (max.)	1150 W
Protection degree	IPX4
Cable length	1.1 m (43 <sup>5</sup> / <sub>16</sub> inches)

---

Flow Pressure Range	0.1 - 0.75 MPa ( 15 - 108 psi)
Ambient Temperature Range	4 - 40 °C ( +39 to +104 °F)
Water Temperature Range	4 - 35 °C ( +39 to +95 °F)
Product Weight	44 kg (97 lbs)
Product Dimension (L × B × H)	827 × 497 × 592 mm ( 32 <sup>5</sup> / <sub>16</sub> × 19 <sup>5</sup> / <sub>16</sub> × 23 <sup>5</sup> / <sub>16</sub> inches)
Load Sit and Lid ( Max. )	150 kg ( 330 lbs)

---

Max. flow rate Rear Wash	650 ml/min ( 1/8 gal/min )	5 levels
Max. flow rate Front Wash	650 ml/min ( 1/8 gal/min )	5 levels
Spray arm position		5 levels
Water temperature	31 - 39 °C ( +88 to +102 °F )	5 levels
Air dryer temperature	30 - 46 °C ( +86 to +115 °F )	5 levels
Seat temperature	29 - 37 °C ( +84 to +98 °F )	5 levels

---

## LEGAL DIRECTIONS

---

This manual contains important information on the intended use, correct operation and proper maintenance of the equipment. Knowledge of and compliance with the instructions of this manual are provided for both the safe use of the equipment and for the safety of its operation and maintenance. In this manual, not all kinds of applications and improper manipulations are considered. In addition, attention is drawn to the following: The content of these instructions is neither part of any previous or existing agreement, commitment or legal relationship, nor does it change from an existing agreement, commitment or legal relationship. Any commitment by AXENT results from the respective warranty. These include the complete and authoritative warranty obligation AXENT. The statements in this manual do not constitute an extension or a restriction of the claims under the warranty provisions. This manual is protected by copyright. Copies and / or translations into other languages may be made only with prior written approval of AXENT.

---

# GUARANTEE

Thank you for selecting our AXENT Switzerland. To ensure that your installation proceeds smoothly, please follow these instructions carefully before you begin. Carefully unpack and examine the item before beginning installation.

ALL INSTALLATION PROCEDURES MUST COMPLY IN STRICT ACCORDANCE WITH APPLICABLE LOCAL PLUMBING AND BUILDING CODES.

PROFESSIONAL LICENSED PLUMBER / CONTRACTOR HIGHLY RECOMMENDED FOR INSTALLATION.

## THANK YOU FOR CHOOSING

---

We appreciate your commitment to AXENT Switzerland. If you encounter any installation or performance problems, please don't hesitate to contact us at 1-800-769-4857.

Thanks again for choosing AXENT Switzerland.

## BEFORE YOU BEGIN

---



### CAUTION!

---

#### Risk of personal injury or product damage

Handle with care. Vitreous china can break or chip if the product is handled carelessly. Observe all local plumbing and building codes.

## CARE AND CLEANING

---



#### DO NOT USE IN-TANK BOWL CLEANERS.

The use of high concentration of chlorine or chlorine-related products can seriously damage fittings in the tank. This damage can cause leakage and property damage. AXENT Switzerland shall not be responsible or liable for any tank fitting failure or damage caused by the use of in-tank bowl cleaners.

# GUARANTEE

## **AXENT LIMITED WARRANTY**

---

AXENT provides you with a ONE-YEAR LIMITED PARTS WARRANTY. This is to guarantee that your newly purchased AXENT product is free from defects in materials and workmanship during normal use when properly installed, serviced and maintained. This warranty is available only to the original purchaser and is not transferable. Proof of purchase is required to show that you are the original purchaser. The warranty is good for one-year from the date of purchase and applies to AXENT products purchased and installed in North America from an AXENT authorized dealers.

AXENT's warranty is limited to repair, replace or make appropriate adjustments at AXENT's sole discretion to properly bring the product back to normal operating function. AXENT reserves the right to perform inspection to the product to properly determine the cause of the defect. AXENT will not be responsible for any labor cost associated with the warranty repair, replacement or adjustment as the warranty only covers parts. AXENT is not responsible for the cost of removal, return and/or re-installation.

This warranty does not apply to the following times.

1. Damage or loss resulting from any misuse, abuse, negligence, improper care, cleaning and maintenance of the product.
2. Damage or loss as a result of using in-tank toilet cleaners.
3. Damages or loss sustained in natural calamity such as fire, earthquake, flood, thunder, electrical storm, etc.
4. Damage or loss resulting from sediments or foreign matter contained in a water system
5. Damage or loss resulting from improper storage, handling, installation or repair of the product.
6. Damage or loss resulting from electrical surges or lightning strikes or other acts or events not caused by or is the fault of AXENT.
7. Damage or loss resulting from normal use, wear and tear. Scratches, fading, reducing of gloss, thinning out of coating over time, etc are all considered wear and tear.

To obtain further information or report a claim, please contact the Axent Customer Service Department at 1-800-769-4857 or write us at [support@axentproducts.com](mailto:support@axentproducts.com) or 3 Musick Irvine, CA 92618.



**AXENT Corporation Ltd.**

[www.axentbath.us](http://www.axentbath.us)  
[support@axentproducts.com](mailto:support@axentproducts.com)  
1-800-769-4857